

PLX-PURE LEAD HIGH RATE

PLX12-500 (12V500W)

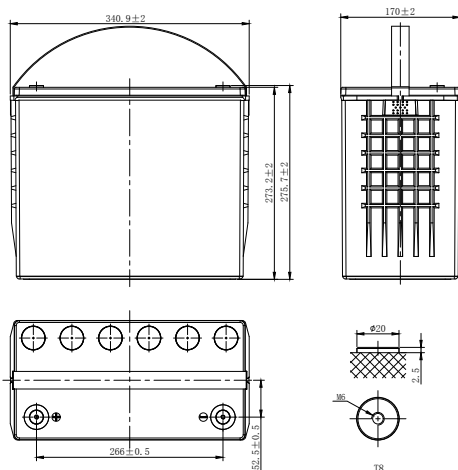

CHARACTERISTICS

Item	Specifications	
Rated Voltage	12V	
Nominal Rate (25°C)	$W_{15}, 1.67V/cell$	500W/cell
Nominal Capacity (25°C)	$C_{10}, 1.80V/cell$	125Ah
Dimension	Length	340.9mm (13.4inches)
	Width	170mm (6.69inches)
	Container Height	273.2mm (10.8inches)
	Total Height	275.7mm (10.9inches)
Approx Weight	41.7kg (91.9lbs)	
Terminal	T8(M6)	
Container Material	PC-ABS (UL94 V-0)	
Short-circuit current	2750A	
Internal Resistance (25°C)	Approx 3.6 mΩ (Fully charged)	
Operating Temp. Range	Discharge	-40~65°C (-40~149°F)
	Charge	-20~54°C (-4~129°F)
	Storage	-20~50°C (-4~122°F)
Nominal Operating Temp. Range	25±3°C (77±5°F)	
Max.Charging Current (25°C)	0.3C	
Charge voltage (25°C)	Standby Use	Equalization Use
	2.27±0.02V/cell	2.35-2.40V/cell
Temp. Coefficient	-3mV/cell/°C	-4mV/cell/°C
	40°C (104°F)	103%
Effect of temp. to Capacity	25°C (77°F)	100%
	0°C (32°F)	86%
	Self Discharge	PLX series batteries can be stored up to 24 months at 25°C(77°F), For higher temperatures the time interval will be shorter.Battery needs to be given a freshening charge when the OCV approach 2.10V/cell or when the maximum storage time is reached, whichever occurs first.

DISCHARGE TABLE

Constant Current Discharge (Amperes) at 25°C (77°F)															
F.V/Time	5min	10min	15min	20min	30min	45min	1h	1.5h	2h	3h	4h	5h	8h	10h	20h
1.85V/cell	321.0	249.6	196.5	174.9	140.9	104.5	85.2	60.1	47.6	35.3	27.3	23.2	15.9	12.3	6.38
1.80V/cell	361.3	287.7	218.9	191.1	150.5	109.8	88.6	62.7	49.8	36.9	28.4	24.3	16.4	12.5	6.50
1.75V/cell	395.0	315.0	237.2	203.9	160.2	112.9	91.1	64.5	51.2	37.8	29.2	24.8	16.6	12.7	6.58
1.70V/cell	425.6	340.6	252.4	214.5	166.3	117.0	94.6	66.1	51.9	38.6	29.7	25.2	16.8	12.8	6.63
1.67V/cell	475.0	358.8	266.1	222.8	173.1	121.6	96.7	67.5	52.9	39.0	30.1	25.4	17.0	12.9	6.68
1.60V/cell	513.4	364.8	275.1	229.0	176.4	123.4	98.3	68.6	53.7	39.5	30.4	25.7	17.2	13.0	6.73
Constant Power Discharge (Watts/cell) at 25°C (77°F)															
F.V/Time	5min	10min	15min	20min	30min	45min	1h	1.5h	2h	3h	4h	5h	8h	10h	20h
1.85V/cell	639.3	488.1	386.4	345.8	280.0	208.6	170.5	120.6	95.6	71.4	55.4	47.3	32.5	25.2	13.2
1.80V/cell	713.9	557.1	426.4	374.3	296.7	217.6	176.3	125.0	99.4	74.0	57.3	49.2	33.4	25.6	13.4
1.75V/cell	766.0	604.2	457.9	395.7	312.8	221.8	179.9	127.6	101.5	75.5	58.5	50.0	33.7	25.8	13.5
1.70V/cell	807.9	646.0	481.4	411.8	321.5	227.5	185.4	130.0	102.3	76.4	59.1	50.4	33.9	26.0	13.5
1.67V/cell	870.0	675.4	500.0	425.2	332.7	235.0	188.4	131.9	103.6	76.8	59.6	50.6	34.1	26.1	13.6
1.60V/cell	887.6	680.3	516.3	432.9	335.8	236.6	189.8	132.7	104.2	77.1	59.7	50.6	34.1	26.1	13.6

PLX-PURE LEAD HIGH RATE

PLX12-500 (12V500W)



APPLICATIONS

- UPS
- Emergency lighting
- Emergency Power supply
- Electric starting
- Power tools

GENERAL FEATURES

- 15 years design life (25°C)
- Utilizes TPPL technology, thin positive grids and unique manufacturing process to maximize corrosion resistance and service life while increasing energy density
- Specifically designed for high-rate discharge applications
- Wide Wpc range of front and top terminal monoblocs
- UL 94 V-0 Case and cover heat sealed and 100% tested to prevent leaks

STANDARDS

- Compliance with IEC 60896 standards
- Classified as "Very Long Life" according to Eurobat
- CE,UL Approved
- Manufactured in Leoch@IATF 16949, ISO 45001,ISO 9001 and ISO 14001 certified production facilities

Discharge Characteristics

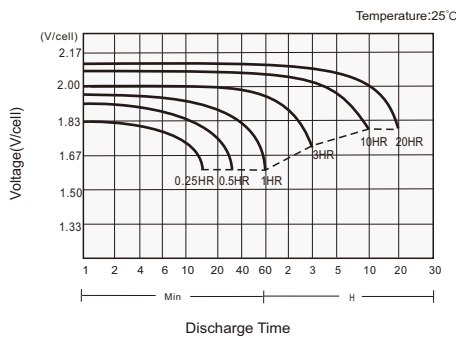

Charging Characteristics

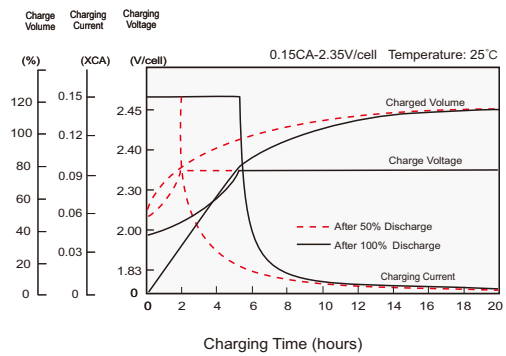

Effects of Temperature on Capacity

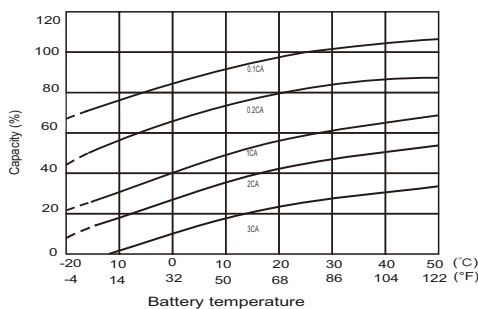

Self Discharge Characteristics

